

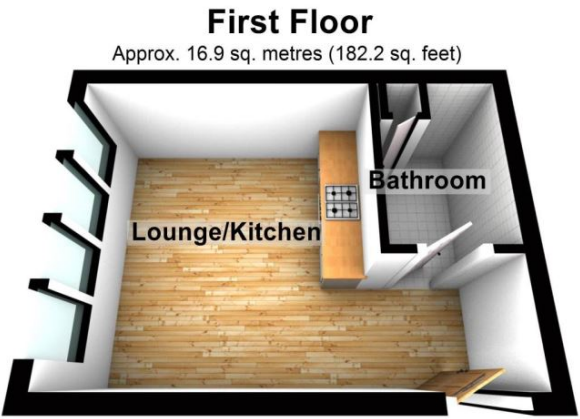

Angel Pavement  
SG8 9AS

£750 Monthly

abode



Total area: approx. 16.9 sq. metres (182.2 sq. feet)

01763259888

This modern top floor studio flat is situated in the heart of Royston Town Centre. The accommodation comprises of; a new kitchen and bathroom, gas central heating, solid wood flooring. For a single occupant only. No Pets. Call us on: 01763 259888 to arrange your viewing!

## First Floor

Approx. 16.9 sq. metres (182.2 sq. feet)

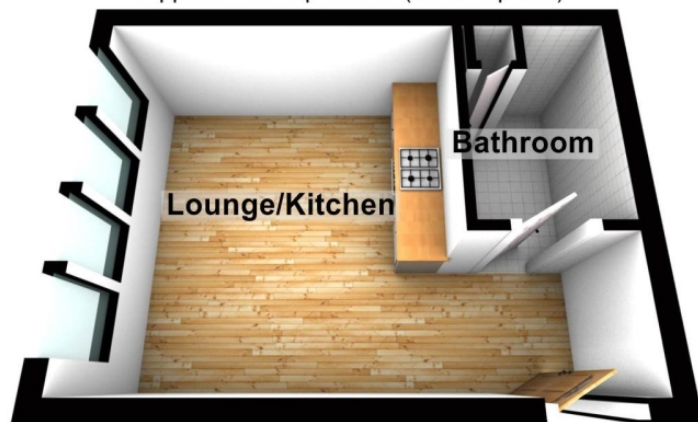

Total area: approx. 16.9 sq. metres (182.2 sq. feet)

Energy Efficiency Rating		
	Current	Potential
<i>Very energy efficient - lower running costs</i>		
(92-100) <b>A</b>		
(81-91) <b>B</b>		
(69-80) <b>C</b>	<b>75</b>	<b>75</b>
(55-68) <b>D</b>		
(39-54) <b>E</b>		
(21-38) <b>F</b>		
(1-20) <b>G</b>		
<i>Not energy efficient - higher running costs</i>		
<b>England &amp; Wales</b>	EU Directive 2002/91/EC	