

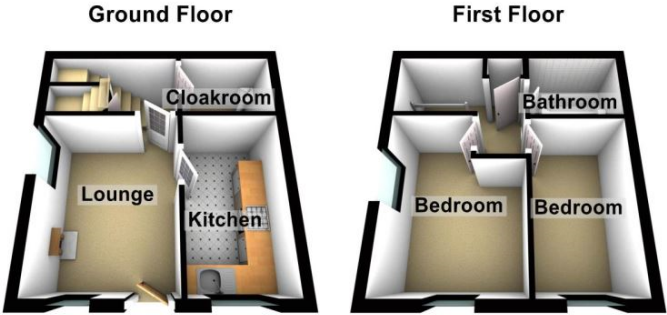

Thriplow Road
SG8 7QT

£1,400 Monthly

abode



01763259888

A well presented two bedroom house located in the sought after village of Fowlmere. The accommodation comprises two bedrooms, lounge, kitchen, bathroom and a downstairs shower room. The property also benefits from an enclosed garden and off road allocated parking. Council tax band B. Available from 20th of September 2025.

Kitchen (Ground Floor)

Lounge (Ground Floor)

Shower Room (Ground Floor)

Bathroom (First Floor)

Bedroom 2 (First Floor)

Master Bedroom (First Floor)

Stairs & Landing

Ground Floor

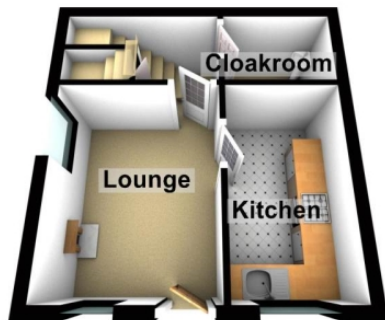

First Floor

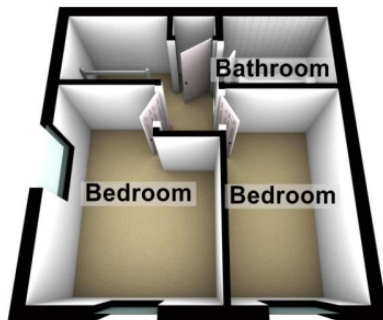

Energy Efficiency Rating		
	Current	Potential
<i>Very energy efficient - lower running costs</i>		
(92-100) A		
(81-91) B		
(69-80) C		
(55-68) D		
(39-54) E		
(21-38) F		
(1-20) G		
<i>Not energy efficient - higher running costs</i>		
England & Wales	EU Directive 2002/91/EC	