

Cavendish Road Dean Park BH1 1RE

£895 Available 03 September 2024

TO LET



Property Features:

- Unfurnished
- First Floor
- High Ceilings
- Electric Heating
- Double Glazed
- Communal Gardens
- Wooden Flooring
- Council Tax Band A

Description

Adams Property Agents are pleased to offer for rent this delightful first floor 1 bedroom flat with fantastic views over Dean Park Cricket Club. The property benefits from 1 double bedroom with fitted wardrobe, separate living room, kitchenette, bathroom, high ceilings, electric heating, first come first serve off road parking available and use of the communal gardens.

Unfortunately no pets or children.

A holding deposit equivalent to one week's rent will be required to secure the property.



EPC Certificate

Energy Efficiency Rating		Environmental Impact (CO ₂) Rating	
Current	Potential	Current	Potential
Very energy efficient - lower running costs (92-100) A (81-91) B (69-80) C (55-68) D (39-54) E (21-38) F (1-20) G Not energy efficient - higher running costs		Very environmentally friendly - lower CO ₂ emissions (92-100) A (81-91) B (69-80) C (55-68) D (39-54) E (21-38) F (1-20) G Not environmentally friendly - higher CO ₂ emissions	
	76	58	36
51			
England & Wales	EU Directive 2002/91/EC	England & Wales	EU Directive 2002/91/EC

Floor Plan

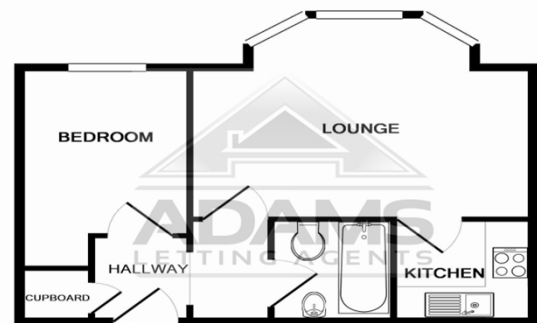

TOTAL APPROX. FLOOR AREA 412 SQ.FT. (38.3 SQ.M.)

Whilst every attempt has been made to ensure the accuracy of the floor plan contained here, measurements of doors, windows, rooms and any other items are approximate and no responsibility is taken for any error, omission, or mis-statement. This plan is for illustrative purposes only and should be used as such by any prospective purchaser. The services, systems and appliances shown have not been tested and no guarantee

Adams Property Agents is a trading style of Adams Property Solutions Limited. Adams Property Solutions Limited is registered in England and Wales at 343 Wimborne Road, Bournemouth, BH9 2AD under Company Registration number 5978578.