



Heath Road | , Norwich, NR3 1JW

£1,000 pcm

****NR3 TERRACE **** Gilson Bailey are delighted to offer this TWO BEDROOM, MID TERRACE HOUSE situated in the highly sought after NR3 area of Norwich. Accommodation comprising lounge, Kitchen/Diner , utility room and bathroom to the ground floor. On the first floor there are TWO BEDROOMS OFF LANDING . Outside there is a low maintenance front garden and a courtyard rear garden. The house benefits from double glazing and gas central heating. EPC Rating D, Tax Band A UNFURNISHED

Available From: 31 July 2026

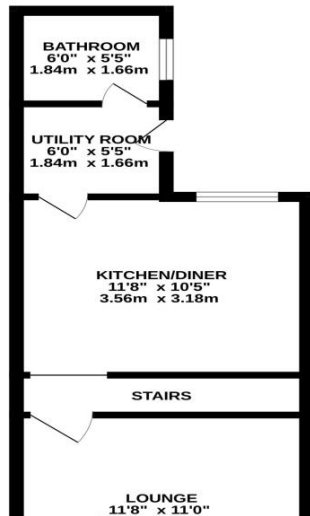

GROUND FLOOR

**Bedroom One (Second Floor)**

3.57m (11'9") x 3.33m (11'0")

Two UPVC windows, radiator and door to over stairs storage.

Bedroom Two (Second Floor)

UPVC window and radiator

First Floor Landing (Second Floor)

Doors to bedrooms one and two.

Agents Note

There may be Furniture/furnishings along with white goods in the property when viewing that are not included in the tenancy . Please contact the office for further details.

Agents Note

Due to high demands, there may be multiple viewings at the same time and cannot guarantee a solo viewing at any one time.

Agents Note

The tenants may still be in residence so these details and photos are only an indication of the property and there could be some requirement for remedial work before the start of a new tenancy.

Outside

Courtyard rear garden with timber decking, gate access to side.

1ST FLOOR

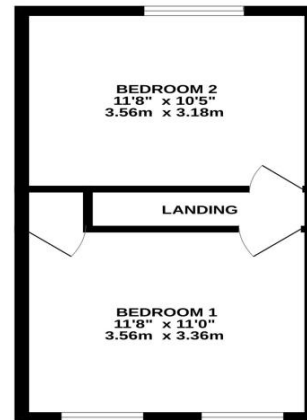
**Bathroom (First Floor)**

Three piece, Low Level WC, hand wash basin and bath with shower over.

Kitchen/Diner (First Floor)

3.56m (11'9") x 3.18m (10'6")

Range of wall and base units, space for cooker, fridge freezer, UPVC window and door to

Lounge (First Floor)

3.55m (11'8") x 3.35m (11'0")

UPVC, radiator and door to

Utility Room (First Floor)

1.87m (6'2") x 1.67m (5'6")

Space for washing machine, door to side and door to

Energy ratings

Directions: Head east on Prince of Wales Rd towards St Vedast St, Follow A147 and A1151 to Stacy Rd, Continue on Stacy Rd. Drive to Heath Rd.