



Ladbroke Place | , Norwich, NR1 4HA

£900 pcm

Gilson Bailey are delighted to offer this TWO BEDROOM, FIRST FLOOR FLAT situated to the east of Norwich within walking distance to the City Centre. Accommodation comprising communal entrance, private entrance hall, 5.38m lounge/diner, kitchen, utility room, TWO BEDROOMS and a bathroom. Outside there is permit parking available. The flat benefits from double glazing, gas heating. EPC: B Council Tax Band: A

Available From: Now



GROUND FLOOR

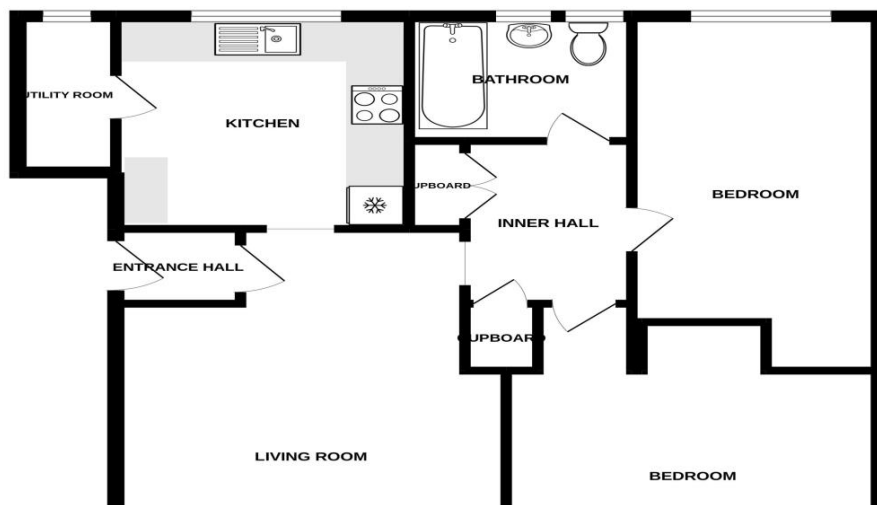

Kitchen (First Floor)

3.19m (10'6") x 2.89m (9'6")

Fitted wall and base units with worktops over, sink and drainer, space for cooker and fridge/freezer, double glazed window.

Lounge/Diner (First Floor)

5.38m (17'8") x 4.10m (13'6")

Double glazed window, radiator.

Utility Room (First Floor)

2.38m (7'10") x 1.02m (3'5")

Space for washing machine.

Local Authority

Norwich City Council, Tax Band A.

Outside

Well maintained communal grounds.

Parking

Residents permit parking.

Bathroom (First Floor)

2.37m (7'10") x 1.88m (6'3")

Panelled bath with shower over, low level WC, hand wash basin, radiator, frosted double glazed window.

Bedroom 1 (First Floor)

4.18m (13'9") x 3.88m (12'9")

Double glazed window, radiator.

Bedroom 2 (First Floor)

5.39m (17'9") x 2.58m (8'6")

Double glazed window, radiator.

Entrance Hall (First Floor)

Private entrance hall accessed via communal entrance lobby, door to lounge.

Energy ratings

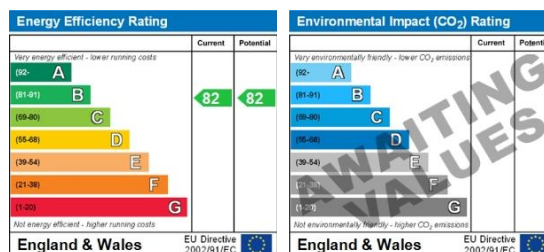

Directions: Proceed down Prince of Wales Road, over the bridge and turn left onto Riverside Rd. Take the 2nd right into St Matthews Rd, at the top proceed straight over into St Leonards Rd. Just past the fish & chip shop turn left and the property on the left where the road bends sharply right..