

Riverdale Court | , The Dales, Brundall, Norwich, NR13 5AF

£750 pcm

Gilson Bailey are delighted to offer this ONE BEDROOM light, bright first floor apartment with outstanding views and set in a cul-de-sac location within easy reach of the village centre, shops and the station. The accommodation comprises of a private entrance hall with storage, large living room with far reaching views, double bedroom, separate modern kitchen, bathroom with shower over the bath, parking, double glazing, gas central heating, Council Tax Band A, UNFURNISHED.

Available From: 23 February 2026



GROUND FLOOR

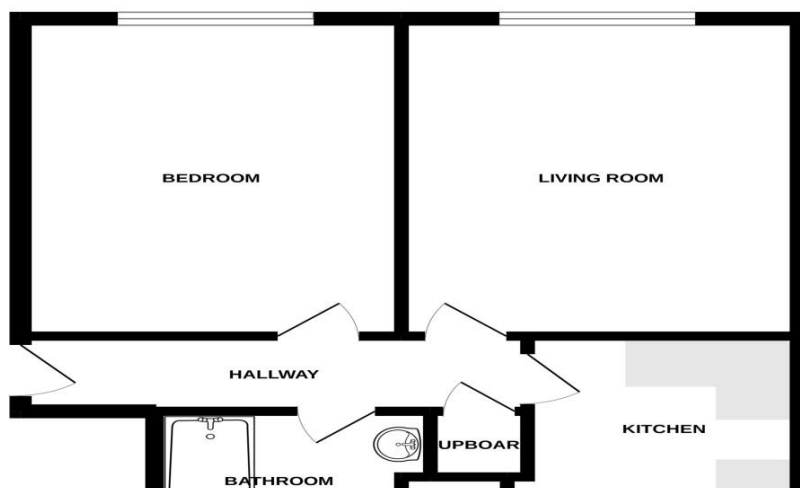

Living Room (First Floor)

4.20m (13'10") x 3.20m (10'6")

Large 14ft long living room with big picture window providing far reaching views. TV point, radiator.

Agents Note

The tenants may still be in residence so these details and photos are only an indication of the property and there could be some requirement for remedial work before the start of a new tenancy.

Agents Note

The tenants may still be in residence so these details and photos are only an indication of the property and there could be some requirement for remedial work before the start of a new tenancy.

Outside

Well maintained communal grounds.

Parking

Residents parking and further on street parking.

Bathroom (First Floor)

Modern white suite comprising bath with shower over, WC and wash basin. Heated towel rail and radiator, frosted window.

Bedroom (First Floor)

4.20m (13'10") x 3.00m (9'11")

Big double bedroom, window with views towards the river, BT point, radiator.

Entrance Hall (First Floor)

Part glazed front door to porch, door to private entrance hall with built in storage cupboard.

Kitchen (First Floor)

3.00m (9'11") x 2.20m (7'3")

Separate modern kitchen with ample storage and work surface. Appliances include electric cooker, space and plumbing for additional appliances.

Energy ratings

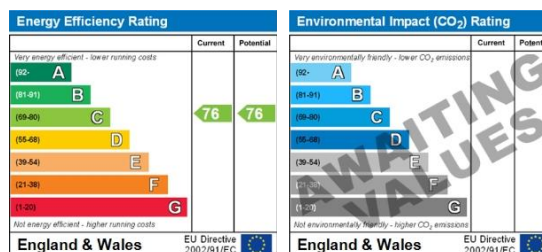

Directions: Leave the city via the A47 heading towards Acle. At the roundabout take the 3rd exit onto Cucumber Lane. At the end the road turns left into The Street. Follow the road over the mini roundabout and then turn 3rd left into The Dales. The property is at the end of the road.