



Shipstone Road | , Norwich, NR3 1JZ

£750 pcm

Gilson Bailey Lettings are delighted to offer this purpose built ONE BEDROOM first floor apartment situated close to local shops, parks, pubs and within easy reach of the City Centre. The accommodation comprises of a private entrance hall with storage cupboards, large living room with door to balcony, separate kitchen, double bedroom, bathroom with shower over the bath, gas central heating, double glazing. Council Tax Band A, UNFURNISHED

Available From: 03 November 2025



GROUND FLOOR
491 sq.ft. (45.6 sq.m.) approx.

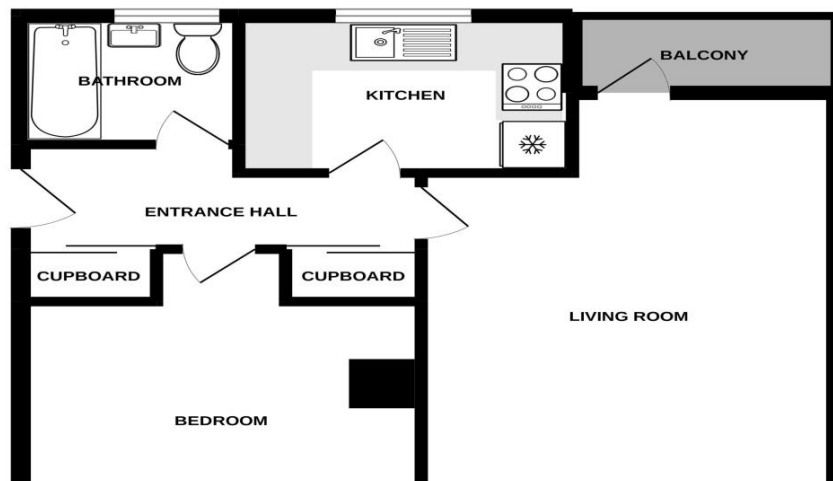

Living Room (First Floor)

5.30m (17'5") x 3.70m (12'2")

Impressive 17ft long living room with two big front aspect windows which allow much daylight in. Glazed door to private balcony, TV point, radiator.

Agents Note

The tenants are in residence so these details and photos are only an indication of the property and some remedial work may be in progress .

Parking

On street permit parking.

Bathroom (First Floor)

White suite comprising bath with shower over, WC and wash basin. Frosted window, extensive tiling, radiator.

Bedroom (First Floor)

3.10m (10'3") x 2.70m (8'11")

Double bedroom, front aspect window, wardrobe recess, radiator.

Entrance Hall (First Floor)

Part glazed front door to entrance hall, two built in storage cupboards. Radiator.

Kitchen (First Floor)

2.80m (9'3") x 2.00m (6'7")

Separate kitchen with ample storage and work surface. Appliances include electric cooker, fridge/freezer and washing machine.

Energy ratings

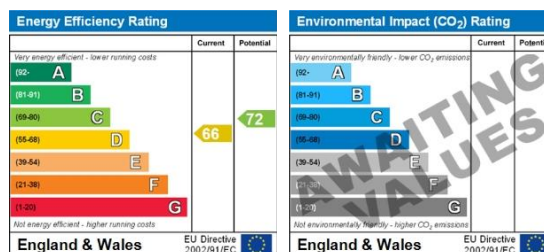

Directions: Leave the city via Magdalen Road, pass the Tesco Metro and Shipstone Road is second left.