



Abbey Court | , Bracondale, Norwich, NR1 2AW

£950 pcm

Gilson Bailey Lettings are delighted to offer this two double bedroom spacious ground floor apartment situated within easy walking distance of the city, yet tucked away in this secluded development. The accommodation comprises of a private entrance hall, large living room, modern kitchen, two double bedrooms, modern bathroom with shower over the bath, double glazing, gas central heating, communal gardens, GARAGE, Council Tax Band B, UNFURNISHED.

Available From: Now



GROUND FLOOR

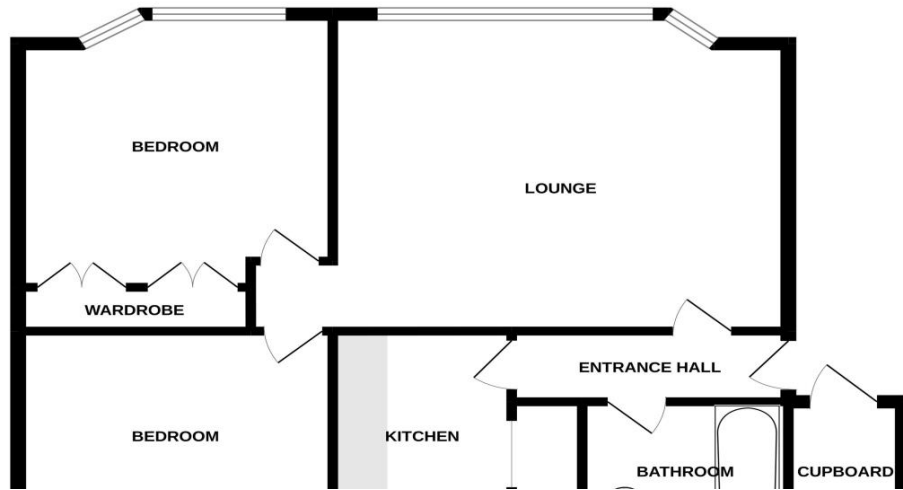

Kitchen (Ground Floor)

2.80m (9'3") x 2.10m (6'11")

Separate modern kitchen with ample storage and work surface.

Living Room (Ground Floor)

4.80m (15'9") x 4.30m (14'2")

Large living room with big front aspect bay window, quality laminate floor, radiator.

Garage & Parking

Single garage in the block. Additional permit parking.

Outside

Very well maintained communal gardens.

Bathroom (Ground Floor)

Modern bathroom suite in white comprising bath with shower over, WC and wash basin. Frosted window, radiator.

Bedroom 1 (Ground Floor)

4.20m (13'10") x 3.60m (11'10")

Double bedroom, front aspect bay window, radiator.

Bedroom 2 (Ground Floor)

3.50m (11'6") x 2.80m (9'3")

Second double bedroom, rear aspect window, radiator.

Entrance Hall (Ground Floor)

Private entrance hall accessed via communal entrance lobby.

Energy ratings

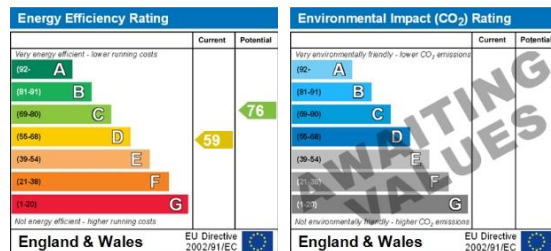

Directions: From Norwich city centre take Ber St to Bracondale/A147, turn left onto Bracondale, Abbey court is situated on your right hand side.