



**Horsford Street | , Norwich, NR2 4LW**

**£750 pcm**

Gilson Bailey are delighted to offer this ONE BEDROOM, GROUND FLOOR FLAT situated in a QUIET CUL-DE-SAC to the west of the city. Accommodation comprises entrance porch, lounge, kitchen, bedroom and a bathroom. Outside there is ONE OFF ROAD PARKING SPACE and communal lawned gardens. The flat benefits from double glazing, storage heating. EPC: C, Council Tax Band: A

Available From: 26 January 2026



GROUND FLOOR

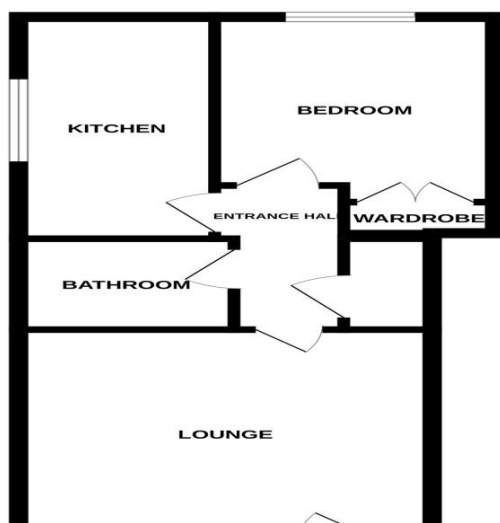

#### Kitchen (Ground Floor)

4.00m ( 13'2") x 1.73m ( 5'9")

Fitted wall and base units with worktops over, sink and drainer, electric hob, fitted oven, space for fridge/freezer and washing machine, double glazed window.

#### Lounge (Ground Floor)

3.83m ( 12'7") x 3.80m ( 12'6")

Double glazed window, storage heater.

#### Outside (Ground Floor)

One off road parking space and communal lawned gardens.

#### Local Authority

Norwich City Council, Tax Band A.

#### Location

Horsford Street is just to the west of Norwich within walking distance of a selection of local shops, amenities and Norwich city centre itself. There is also good access to both the University of East Anglia and the Norfolk and Norwich University Hospital.

#### Accommodation Comprises (Ground Floor)

Front door to:

#### Bathroom (Ground Floor)

1.99m ( 6'7") x 1.49m ( 4'11")

Panelled bath with shower over, low level WC, hand wash basin, frosted double glazed window.

#### Bedroom (Ground Floor)

3.40m ( 11'2") x 2.70m ( 8'11")

Double glazed window, storage heater, built in wardrobe.

#### Entrance Porch (Ground Floor)

Door to:

## Energy ratings

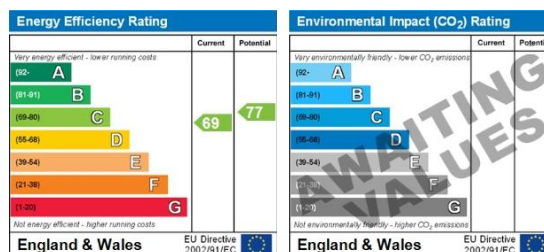

**Directions:** Head south-east on Prince of Wales Rd towards Eastbourne Place, follow A147 to Barker St. At the roundabout, take the 2nd exit onto Barker St, turn right onto Heigham St, turn right onto Horsford St.