



**Douro Place | , Norwich, NR2 4BQ**

**£850 pcm**

Gilson Bailey Lettings are delighted to offer this spacious TWO DOUBLE BEDROOM 2nd floor apartment situated close to local shops, restaurants and within easy reach of the City centre. The accommodation comprises of a private entrance hall accessed via secure communal entrance lobby, large living room with vaulted ceiling, private balcony, kitchen with appliances, two double bedrooms both with built in wardrobes, modern bathroom, gas central heating, double glazing, communal gardens, on street permit parking, Council Tax Band A, UNFURNISHED

Available From: 30 June 2025



## GROUND FLOOR

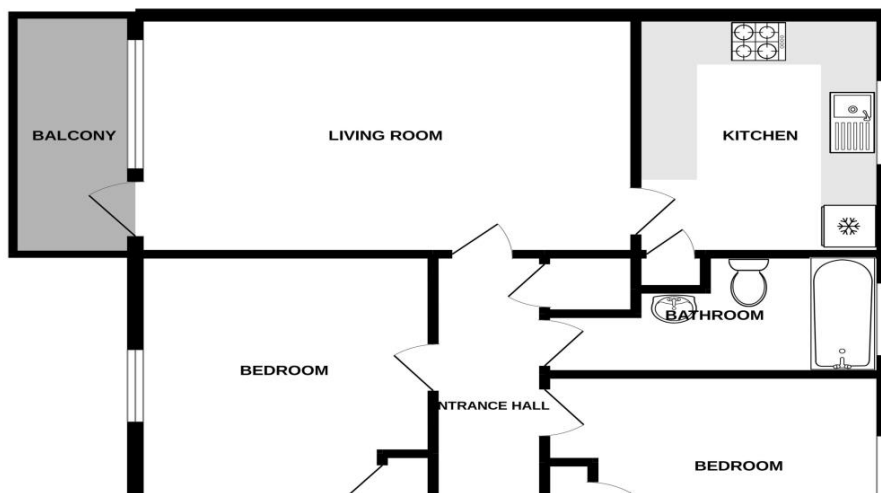

### Bedroom 2 (Second Floor)

3.20m ( 10'6") x 2.50m ( 8'3")

Second double bedroom, front aspect window, built in single wardrobe, radiator.

### Entrance Hall (Second Floor)

Part glazed front door to private entrance hall accessed via secure communal entrance lobby. Built in storage cupboard, radiator, entry phone, doors to all rooms.

### Kitchen (Second Floor)

3.10m ( 10'3") x 2.50m ( 8'3")

Modern kitchen with ample storage and work surface. Appliances include gas cooker, fridge/freezer and washing machine.

### Living Room (Second Floor)

5.50m ( 18'1") x 3.10m ( 10'3")

Large living room with full width windows to rear aspect, vaulted ceiling and skylight windows which provide a bright and welcoming feel to the room. Glazed door to private covered balcony, TV / BT points, radiator.

### Parking

On street permit parking.

### Outside (Ground Floor)

Secure private storage cupboard. Well maintained communal garden area for residents use.

### Balcony (Second Floor)

Private covered balcony with views out over the communal gardens.

### Bathroom (Second Floor)

Modern white suite comprising bath, WC and wash basin. Frosted window, radiator.

### Bedroom 1 (Second Floor)

4.40m ( 14'6") x 3.10m ( 10'3")

Double bedroom, rear aspect window overlooking the communal gardens. Built in double wardrobe, radiator.

## Energy ratings

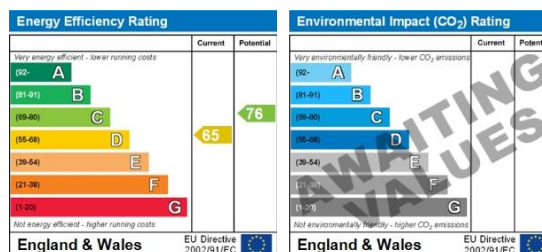

**Directions:** Leave the City centre via the inner ring road onto Dereham Road. Douro Place is the 4th turning on the left.