



Mavish Close | , Norwich, Norfolk, NR5 9PJ

**£645 pcm**

**\*\*MODERN END TERRACE HOUSE \*\*** Gilson Bailey are delighted to offer this WELL PRESENTED, TWO BEDROOM, END TERRACE HOUSE situated in a peaceful location to the west of Norwich close by to the University and Hospital. Accommodation comprising entrance hall, lounge and kitchen/diner and WC to the ground floor. On the first floor there are TWO BEDROOMS and a bathroom off landing ROOM. Outside there are low maintenance gardens to the front and rear , driveway with parking. . The house benefits from UPVC double glazing, gas heating and is being REDECORATED THROUGHOUT and NEWLY FITTED CARPETS. EPC RATING C. COUNCIL TAX BAND B.

Available From: Now

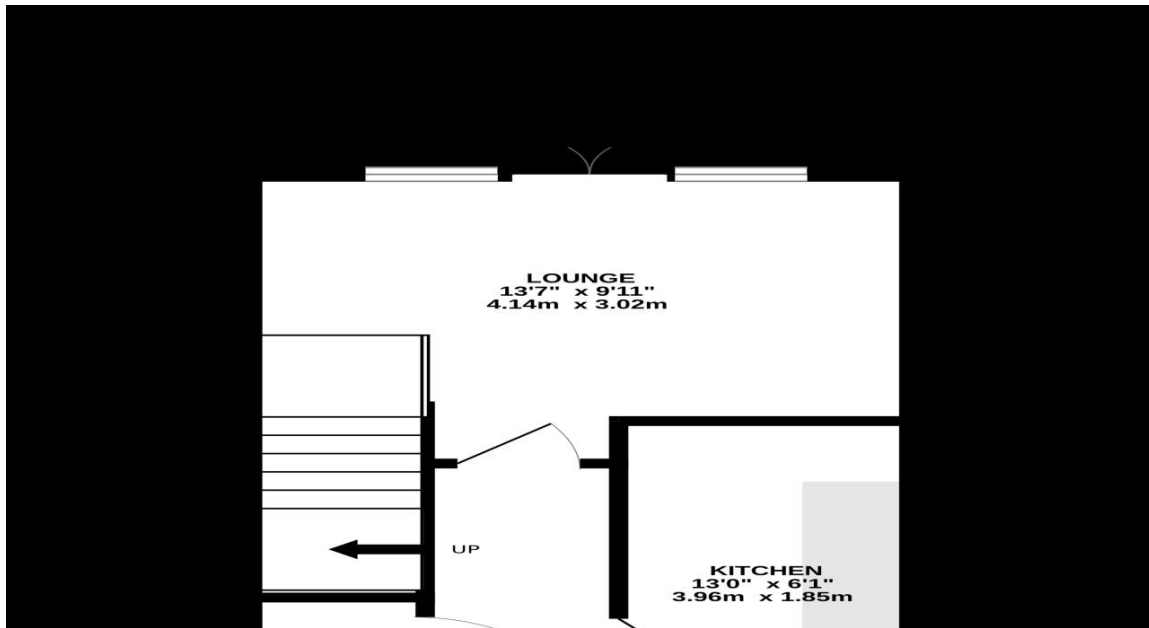

**Bedroom One**

4.16m ( 13'8") x 3.13m ( 10'4")  
UPVC window , radiator, built bin wardrobe.

**Bedroom Two**

3.15m ( 10'5") x 2.22m ( 7'4")  
UPVC window , radiator .

**Entrance Hall**

Radiator , doors to Lounge/Diner, Kitchen, WC and stairs to first floor.

**Kitchen**

3.96m ( 13'0") x 1.80m ( 5'11")  
Wall and base units , single sink , stainless steel fitted oven and hob , extractor , space for washing machine , fridge/freezer , gas boiler , UPVC window.

**Lounge/Diner**

4.15m ( 13'8") x 3.10m ( 10'3")  
UPVC window , radiator , UPVC patio doors to rear.

**Outside**

Front garden , driveway with parking. To the rear is a recently lawned garden , shingle , enclosed by fencing.

**Agents Note**

The tenants may still be in residence so these details and photos are only an indication of the property and there could be some requirement for remedial work before the start of a new tenancy.

**Agents Note**

There may be Furniture/furnishings along with white goods in the property when viewing that are not included in the tenancy . Please contact the office for further details.

**Agents Note**

Due to high demands, there may be multiple viewings at the same time and cannot guarantee a solo viewing at any one time.

**Bathroom**

LLWC , hand wash basin , bath with shower over , radiator , UPVC window.

## Energy ratings

Directions: