



Badger Road | , Norwich, Norfolk, NR5 0UN

£950 pcm

****GILSON BAILEY LETTINGS **** are delighted to offer this well presented, Two-Bedroom, Townhouse located in a modern development in the highly sought after suburb of COSTESSEY close by to both the UEA and UNIVERSITY HOSPITAL. Accommodation comprising Entrance Hall, Lounge, kitchen and WC to the ground floor. On the first floor there are Two Double Bedrooms and a Bathroom off landing. Outside there is a CARPORT offering off road parking and an enclosed lawned rear garden. The house benefits from UPVC double glazing and gas central heating . Tax Band B, EPC C. UNFURNISHED

Available From: 22 September 2025



GROUND FLOOR

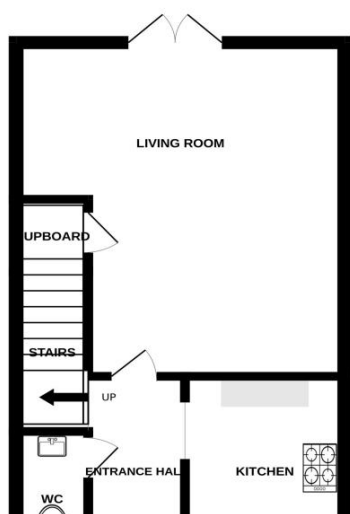

WC (Ground Floor)

Low level WC, hand wash basin, radiator, frosted UPVC double glazed window.

Bedroom One (First Floor)

2.87m (9'5") x 4.01m (13'2")

UPVC Double glazed window, radiator, storage cupboard.

Bedroom Two (First Floor)

2.97m (9'9") x 3.98m (13'1")

UPVC Double glazed window, radiator.

First Floor Landing (First Floor)

Doors to Bedrooms One, Two and Bathroom.

Accommodation Comprises

Front door to:

Outside

Carport with allocated parking. lawned rear garden enclosed by timber fencing, gate with access to rear.

1ST FLOOR

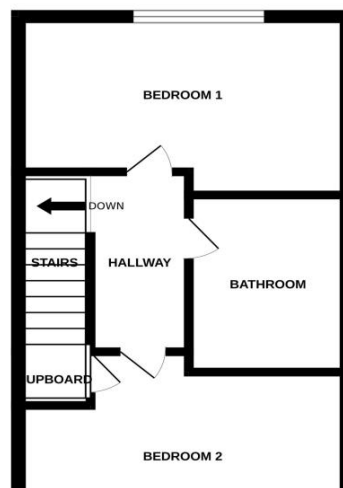

Bathroom (Ground Floor)

Three-piece suite, Low Level WC, hand wash basin, bath with shower over, radiator.

Entrance Hall (Ground Floor)

Doors to lounge, kitchen, WC and stairs to first floor.

Kitchen (Ground Floor)

2.95m (9'9") x 1.93m (6'4")

Fitted wall and base units with worktops over, sink and drainer, stainless steel fitted oven and hob, space for fridge/freezer, washing machine and dish washer UPVC double glazed window, wall mounted gas boiler.

Lounge (Ground Floor)

3.98m (13'1") x 2.97m (9'9")

UPVC patio doors to rear, radiator, door to storage cupboard.

Energy ratings

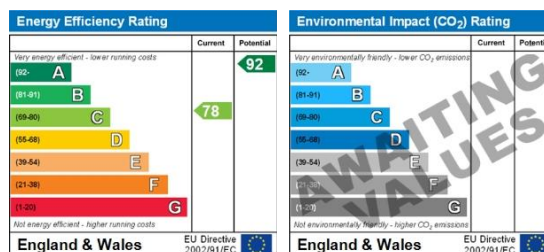

Directions: Leave the city via the Dereham Road. Proceed for approx. 2 miles and continue straight at the lights by the Roundhouse medical centre. Take the next left into Lord Nelson Drive and take the 1st right into Badger Road.