

Merthyr Road, Trallwn, Pontypridd, CF37 4DH
£160,000



- Two Double Bedrooms
- Low Maintenance Rear Garden
- No Onward Chain
- South-East Facing
- Former Three Bedroom With Potential To Reinstate
- Ideal First Time Purchase
- Great A470/M4

Description...

James Douglas is delighted to welcome this two bedroom (former three bedroom) terrace property to the market. Being sold with no onward chain. Set in the ever popular area of Trallwn, Pontypridd, near The Common/Cilfynydd. The perfect first-time-buy, investment (rental complaint) or for someone looking to upsize. In brief terms the accommodation comprises an entrance hallway, living room/dining room and kitchen all on the ground floor. Upstairs, there are two double bedrooms and a family bathroom. There is also an accessible boarded loft space. Mains gas fired central heating (combi boiler) and UPVC double glazed windows and doors throughout. On-street parking to the front. A two tier, south-east facing low maintenance rear garden complemented by patio slabs. Rear access. EPC D potential C. Council tax band C.

****NO ONWARD CHAIN****

****PERFECT FIRST TIME BUY OR INVESTMENT OPPORTUNITY****

****FORMER THREE BEDROOM TERRACE WITH POTENTIAL TO REINSTATE THIRD BEDROOM****

****3D WALK THROUGH AVAILABLE****

Merthyr Road is within reasonable walking distance of Pontypridd town centre or within a few minutes drive. Pontypridd town centre includes a wide range of shops and sporting and recreational facilities. The local primary schools are Coedpenmaen County Primary School & Trallwng Primary School with the local high school being Pontypridd High School. There is a useful mainline railway station in Pontypridd town centre. Easy access to the M4 motorway brings other major centres including the capital city of Cardiff, Newport and Swansea within commuting distance.

Additional Information

Tenure: Freehold
EPC: D
Council Tax Band: C

Accommodation...

- Entrance Hallway
- Living/Dining Room
- Kitchen
- Landing
- Bedroom One
- Bedroom Two
- Bathroom
- Outside
- Directions





Floorplan

Approx Gross Internal Area
77 sq m / 827 sq ft

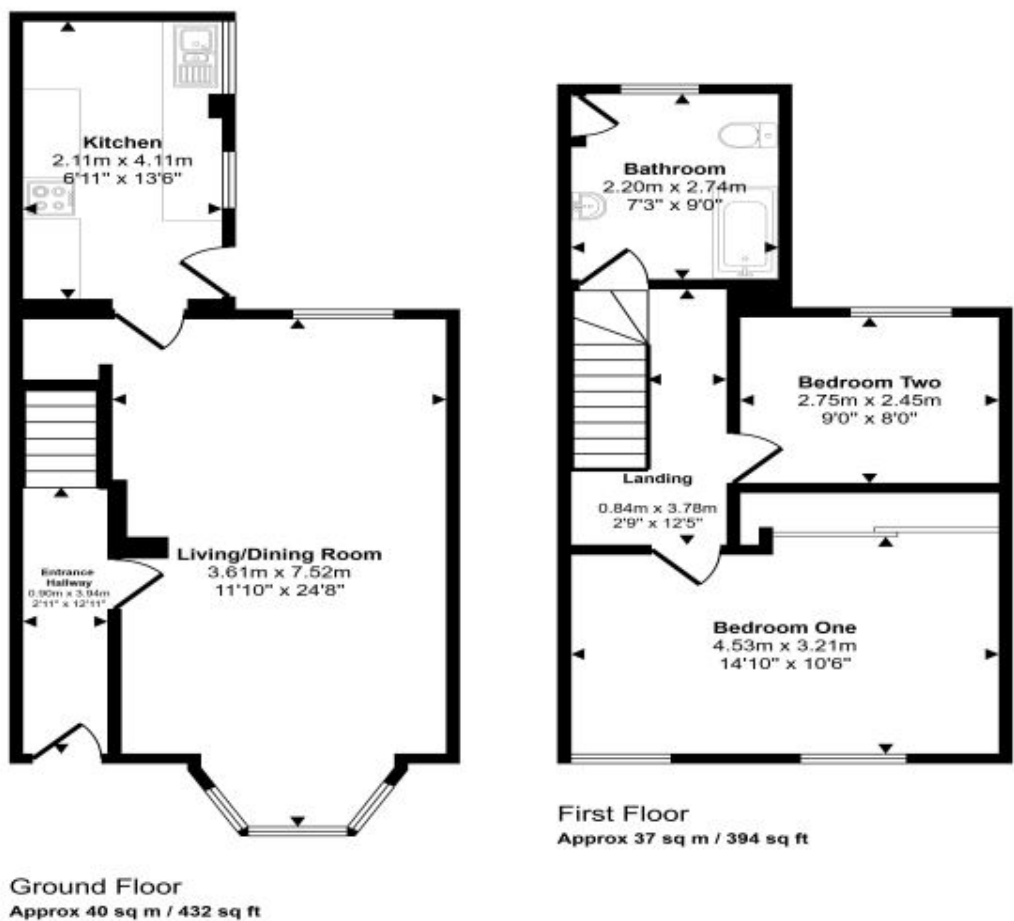

This floorplan is only for illustrative purposes and is not to scale. Measurements of rooms, doors, windows, and any items are approximate and no responsibility is taken for any error, omission or mis-statement. Icons of items such as bathroom suites are representations only and may not look like the real items. Made with Made Snappy 360.

Energy Rating

