

**Marble
Square**

**The Buttercup
2 bedroom house**



Marble Square

The Buttercup 2 bedroom house

Plots as drawn: 13, 15, 22, 26, 28, 30 and 245
Plots handed: 14, 16, 23, 27, 29, 31 and 244

60.48 sq.m / 651 sq.ft

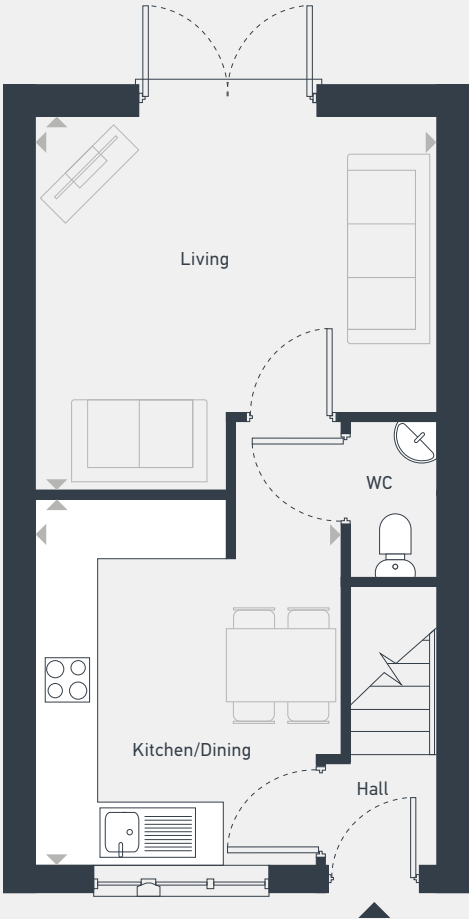

GROUND FLOOR

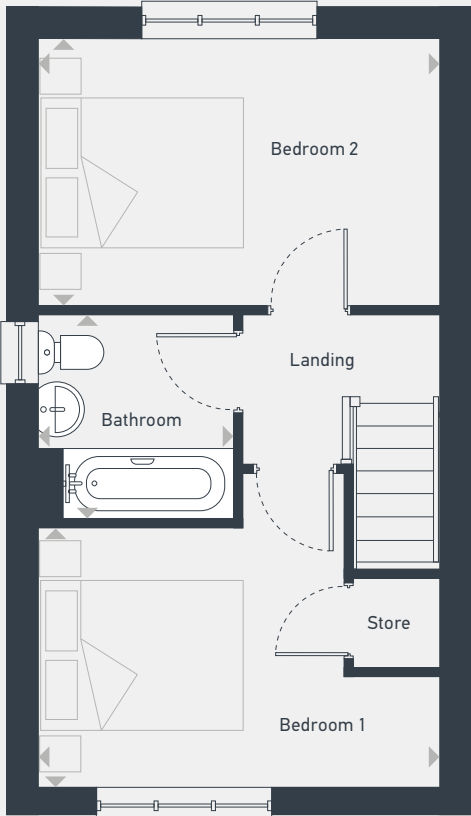

FIRST FLOOR

ST: Storage WC: Water Closet

DIMENSIONS	m	ft
Living	3.99m x 3.72m	13'1" x 12'2"
Kitchen/Dining	3.63m x 3.03m	11'11" x 9'11"

DIMENSIONS	m	ft
Bedroom 1	3.99m x 2.67m	13'1" x 8'9"
Bedroom 2	3.99m x 2.56m	13'1" x 8'5"
Bathroom	2.02m x 1.94m	6'7" x 6'4"



0115 671 0397 | sales@thesohub.co.uk | placesforpeople.co.uk/marble-square
Marble Square, Nightingale Road, Osmaston, Derby DE24 8BF

Please note: All CGIs, layouts and floor plans, configurations, maps and information are intended for guidance only and accuracy of this information cannot be relied upon by prospective purchasers who must make their own enquiries to satisfy themselves by inspection or otherwise as to the correct detail. Sizes and dimensions approximate and subject to change.