



10 Weymouth Street, London, W1W, W1W 5BX

- £1,100 Weekly
- Available 21 August 2024
- Furnished
- Two double bedrooms
- Two bathrooms
- 2nd floor with lift
- Over 750 sq ft
- Balcony
- Concierge

Two double bedroom apartment with a private balcony, in a well maintained development with a concierge and lift access. Located on the second floor with approximately 764 sq ft of internal accommodation, the apartment has two bathrooms (one ensuite) and a separate fully fitted kitchen.

Extremely well connected with easy access to Regents Park and surrounding amenities. Being centrally located in Marylebone, it is just a 0.2 mile walk to Great Portland Street tube station (Hammersmith & City, Circle and Metropolitan lines) and a 0.3 mile walk to Regents Park station (Bakerloo line). Oxford Circus station (Central, Victoria and Bakerloo lines) is also only a 0.5 mile walk away and beneficial for all of the local amenities and shops within easy reach, as well as a 0.6 mile walk to Goodge Street

TYERS • YAN

MANAGEMENT

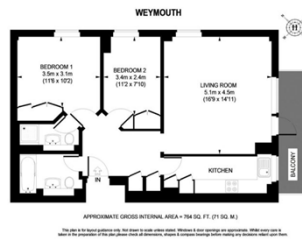

TYERS • YAN

TYERS • YAN

MANAGEMENT

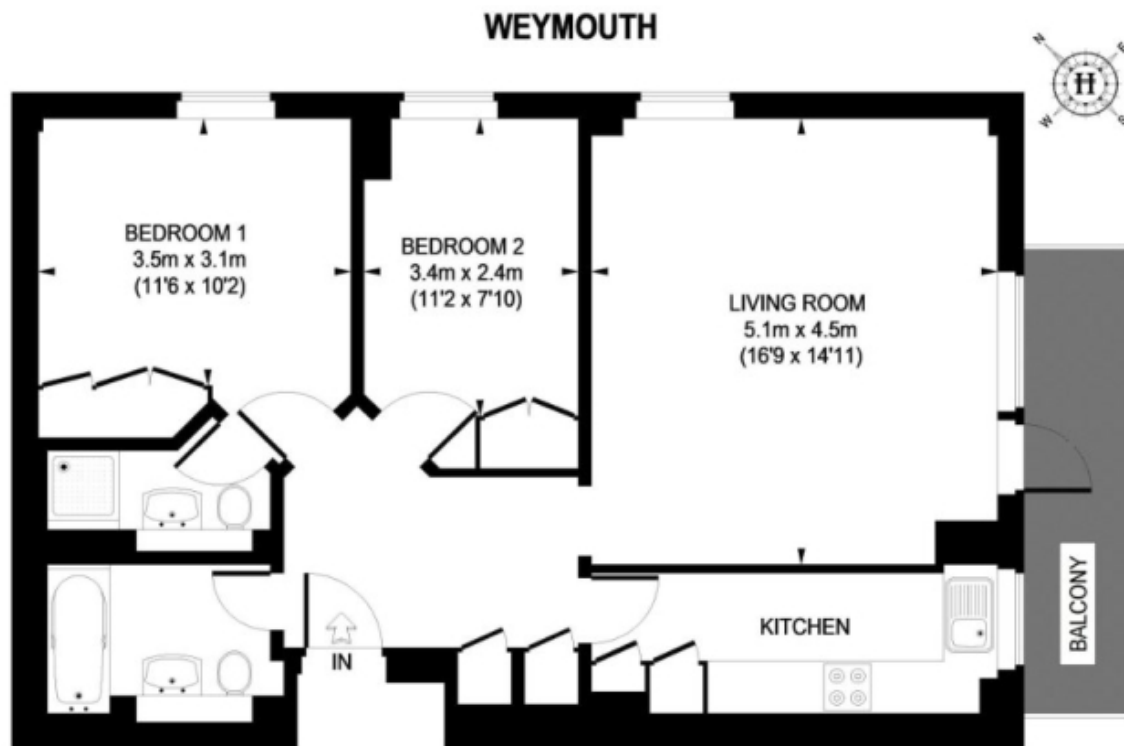

APPROXIMATE GROSS INTERNAL AREA = 764 SQ. FT. (71 SQ. M.)

This plan is for layout guidance only. Not drawn to scale unless stated. Windows & door openings are approximate. Whilst every care is taken in the preparation of this plan, please check all dimensions, shapes & compass bearings before making any decisions reliant upon them.

Energy Efficiency Rating		
	Current	Potential
Very energy efficient - lower running costs		
(92- A		
(81-91) B		
(69-80) C	75	79
(55-68) D		
(39-54) E		
(21-38) F		
(1-20) G		
Not energy efficient - higher running costs		
England & Wales	EU Directive 2002/91/EC 	

The graph shows this property's current and potential energy efficiency.

Properties are given a rating from A (most efficient) to G (least efficient).

Properties are also given a score. The higher number the lower your fuel bills are likely to be.

For properties in England and Wales:

the average energy rating is D
the average energy score is 60