



Cedar House, 39-41 Nottingham Place, London, W1U,

- £950 Weekly
- Available Now
- Furnished
- Two double bedrooms
- One bathroom
- Guest WC
- 1st floor with lift
- Quiet central location
- Balcony
- Approx. 620 sq ft

Two double bedroom apartment situated on the 1st floor (with lift access) of a popular period building in Marylebone and offering over 600 sq ft of lateral living space.

Accommodation comprises a semi open plan living room and kitchen with high ceilings and bay windows, two double bedrooms with fitted wardrobes a separate bathroom with bath and shower as well as a guest WC.

Quiet central location in the heart of Marylebone, moments from local transport links including Marylebone and Baker street stations as well as the boutique shops and cafes on the Marylebone high street.

TYERS • YAN

MANAGEMENT



TYERS • YAN

TYERS • YAN MANAGEMENT

NOTTINGHAM PLACE

Approximate Gross Internal Area
618 sq. ft. (57.4 sq. m.)

CH
11'0"/3.3 = Ceiling Height

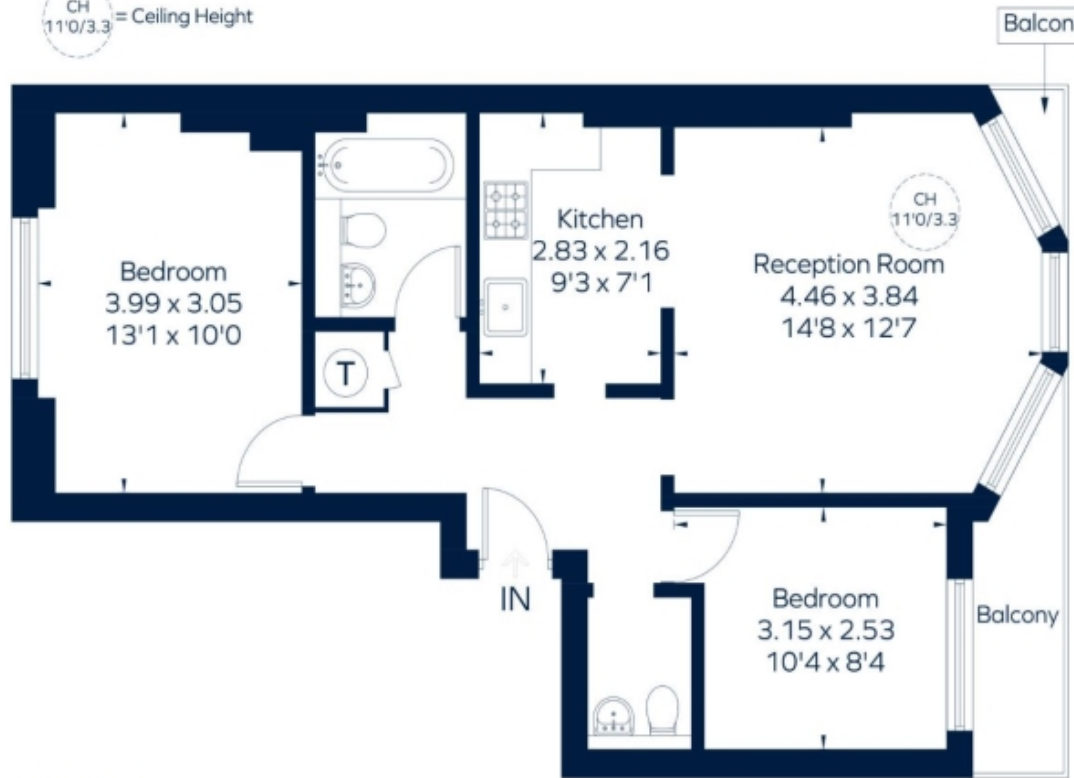

First Floor

This plan is for layout guidance only. Not drawn to scale unless stated. Windows and door openings are approximate. Whilst every care is taken in the preparation of this plan, please check all dimensions, shapes and compass bearings before making any decisions reliant upon them. ID: 1056730



Energy Efficiency Rating		
	Current	Potential
Very energy efficient - lower running costs		
(92- A)		
(81-91) B		81
(69-80) C	72	
(55-68) D		
(39-54) E		
(21-38) F		
(1-20) G		
Not energy efficient - higher running costs		
England & Wales	EU Directive 2002/91/EC 	

The graph shows this property's current and potential energy efficiency.

Properties are given a rating from A (most efficient) to G (least efficient).

Properties are also given a score. The higher number the lower your fuel bills are likely to be.

For properties in England and Wales:

the average energy rating is D
the average energy score is 60